

# Tile Flashing System PRODUCT GUIDE

Exploded Product View/B.O.M. – 1

Installation Instructions – 2

Specifications – 3

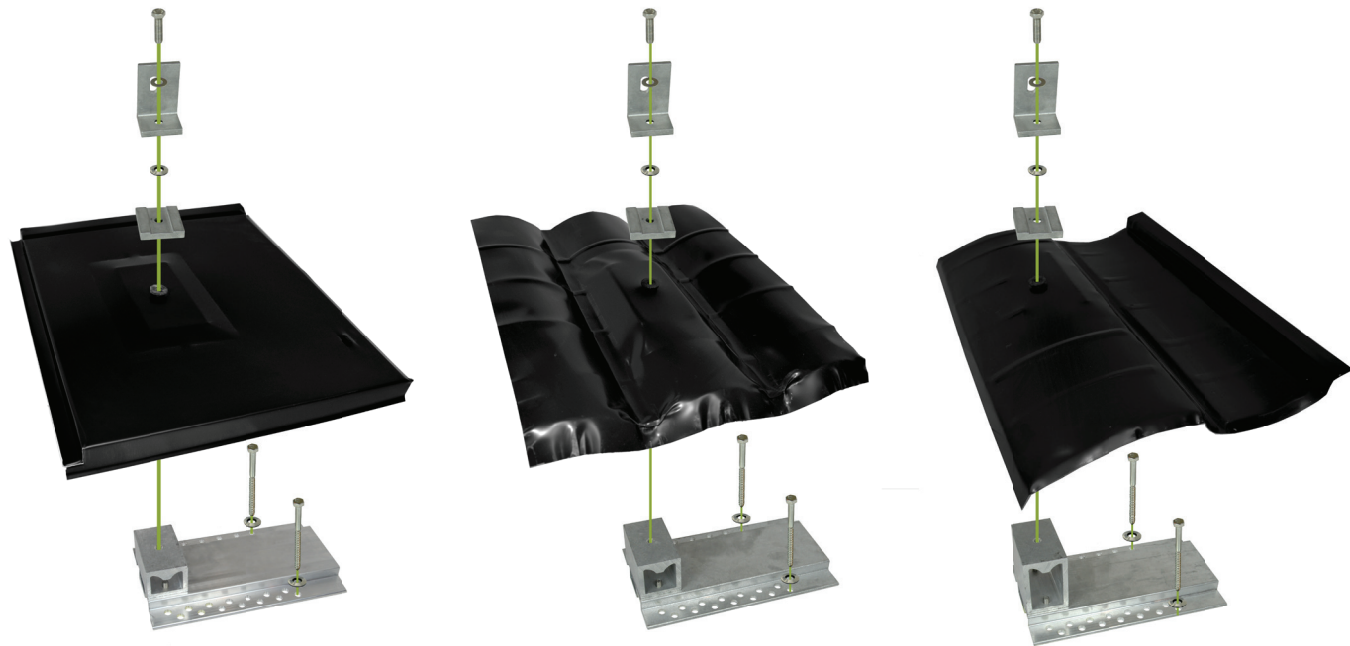

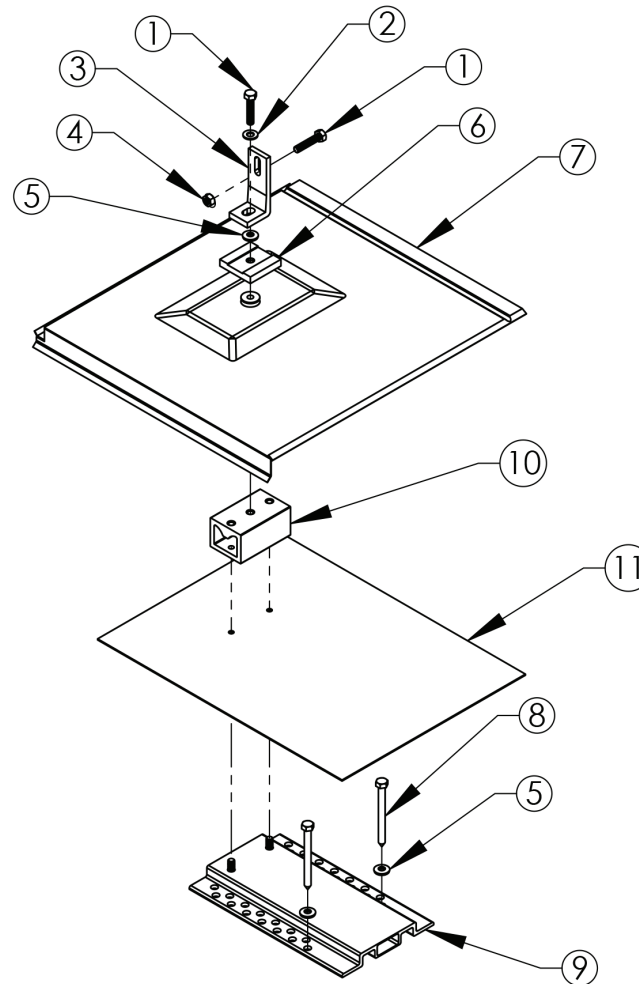

ITEM NO.	DESCRIPTION	QTY
1	5/16"-18 X 1.5" Fully Threaded Hex Head Cap Screw 18.8 SS	2
2	5/16" Flat Washer 18.8 SS	1
3	Customer Supplied Attachment Bracket	1
4	5/16"-18 Hex Flange Nut 18.8 SS	1
5	5/16" ID EPDM Bonded Washer 18.8 SS	3
6	CP-SQ-Slotted (Sold Separately)	1
7	Flat Tile Flashing	1
8	5/16" x 4.0" or 4.5" Hex Head Lag Screw 18.8 SS	2
9	Flat Tile Base (Preassembled to Pedestal)	1
10	Flat Tile Pedestal (Preassembled to base)	1
11	Optional Synthetic Underlayment (Sold Separately)	1

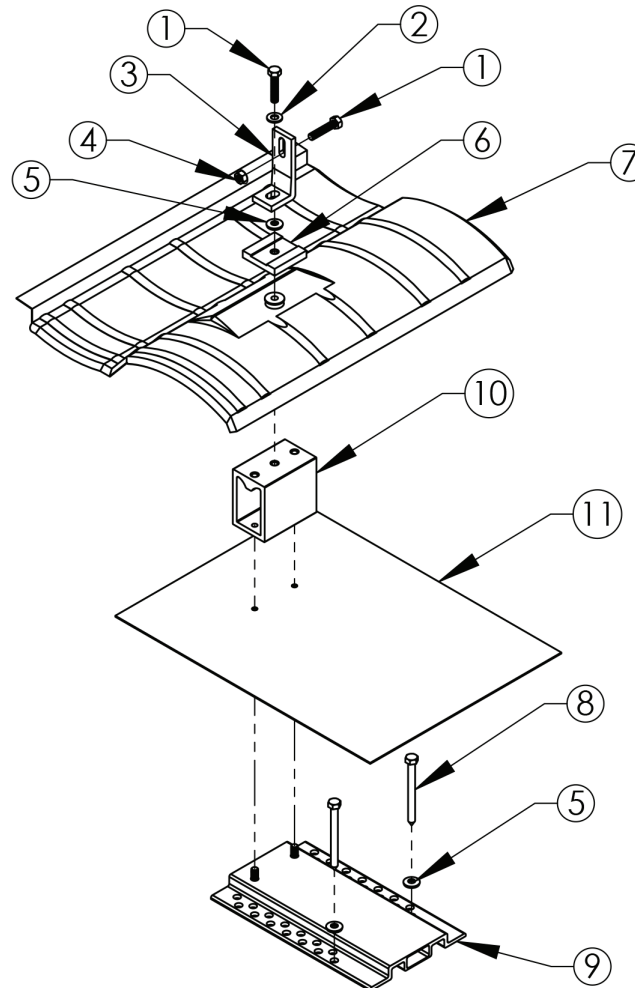

ITEM NO.	DESCRIPTION	QTY
1	5/16"-18 X 1.5" Fully Threaded Hex Head Cap Screw 18.8 SS	2
2	5/16" Flat Washer 18.8 SS	1
3	Customer Supplied Attachment Bracket	1
4	5/16"-18 Hex Flange Nut 18.8 SS	1
5	5/16" ID EPDM Bonded Washer 18.8 SS	3
6	CP-SQ-Slotted (Sold Separately)	1
7	S Tile Flashing	1
8	5/16" x 4.0" or 4.5" Hex Head Lag Screw 18.8 SS	2
9	S Tile Base (Preassembled to Pedestal)	1
10	S Tile Pedestal (Preassembled to Base)	1
11	Optional Synthetic Underlayment (Sold Separately)	1

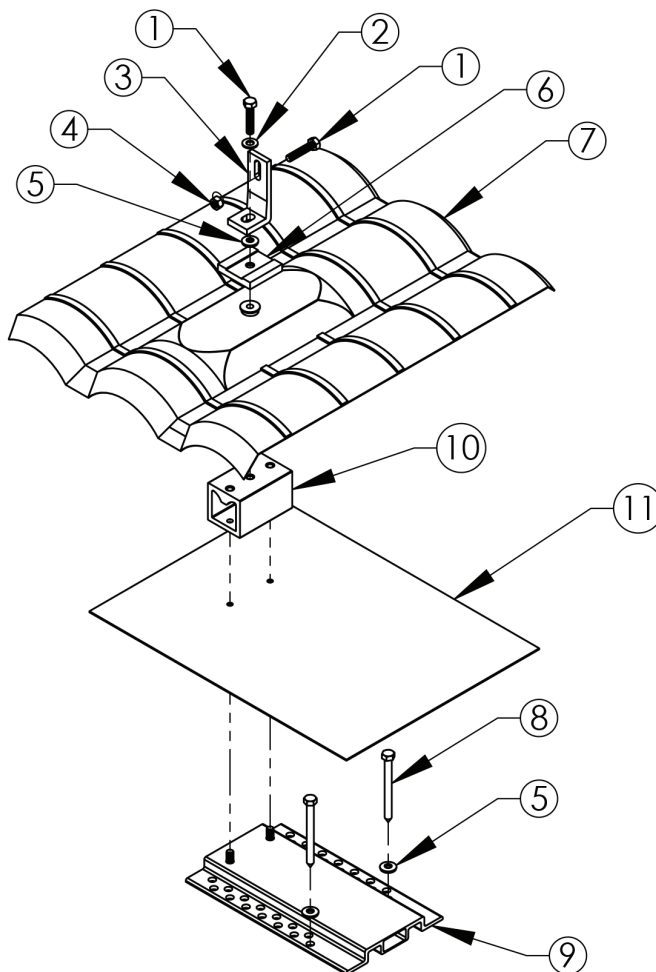

ITEM NO.	DESCRIPTION	QTY
1	5/16"-18 X 1.5" Fully Threaded Hex Head Cap Screw 18.8 SS	2
2	5/16" Flat Washer 18.8 SS	1
3	Customer Supplied Attachment Bracket	1
4	5/16"-18 Hex Flange Nut 18.8 SS	1
5	5/16" ID EPDM Bonded Washer 18.8 SS	3
6	CP-SQ-Slotted (Sold Separately)	1
7	W Tile Flashing	1
8	5/16" x 4.0" or 4.5" Hex Head Lag Screw 18.8 SS	2
9	W Tile Base (Preassembled to Pedestal)	1
10	W Tile Pedestal (Preassembled to base)	1
11	Optional Synthetic Underlayment (Sold Separately)	1



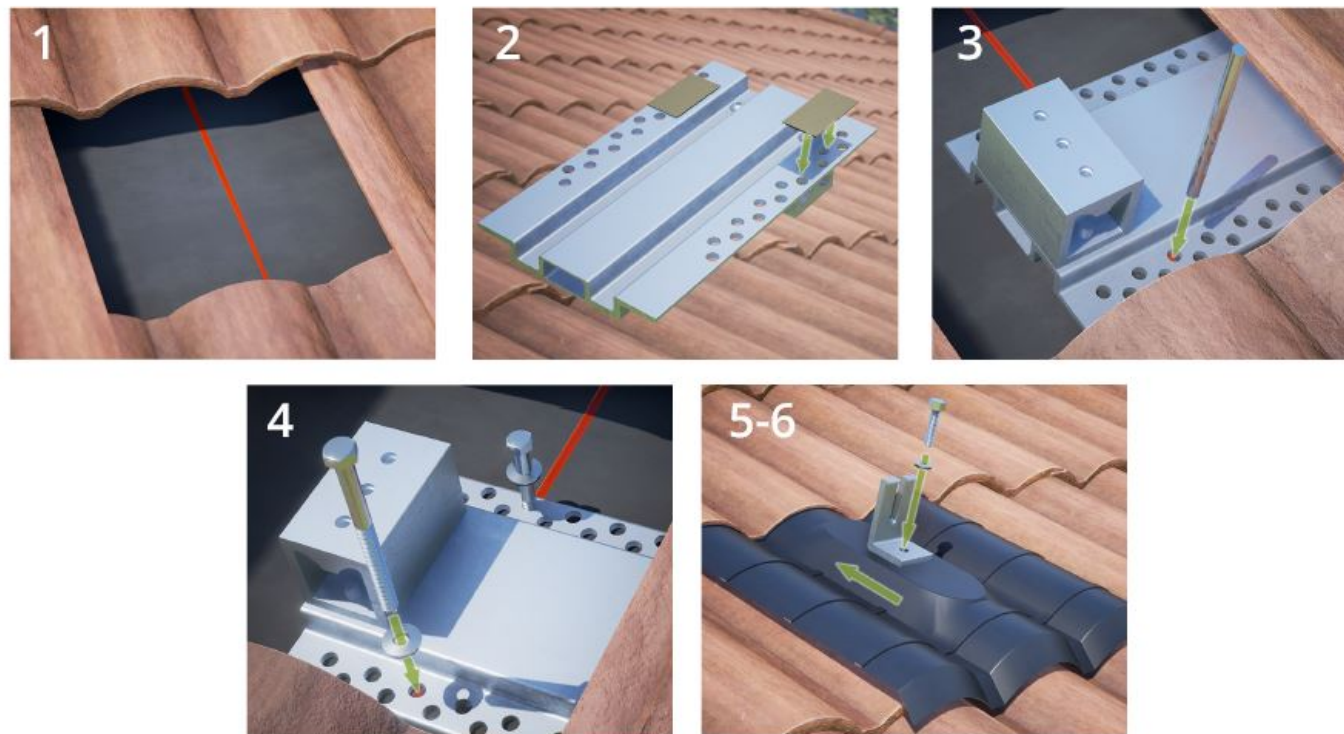

## Tile Flashing System

1. Locate rafter in the typical manner. Remove tile.
2. Remove clear film from butyl tape and align edges of base with edges of butyl tape. Press down firmly on the tile base.
3. Predrill lag bolt holes through base and butyl tape.
4. Remove release paper from bottom of butyl tape. Place base in proper location and press down firmly. Backfill holes with sealant. Install lag bolts in predrilled locations.
5. Install Flashing. \*Always install one flashing prior to installing fasteners to verify layout\*
6. Attach compression bracket with provided 5/16"-18 x 1.25" Hex Bolt and EPDM bonded washer, torque to 120-150 in-lb.
7. Re-align adjacent tiles as necessary to create a watertight roof connection.

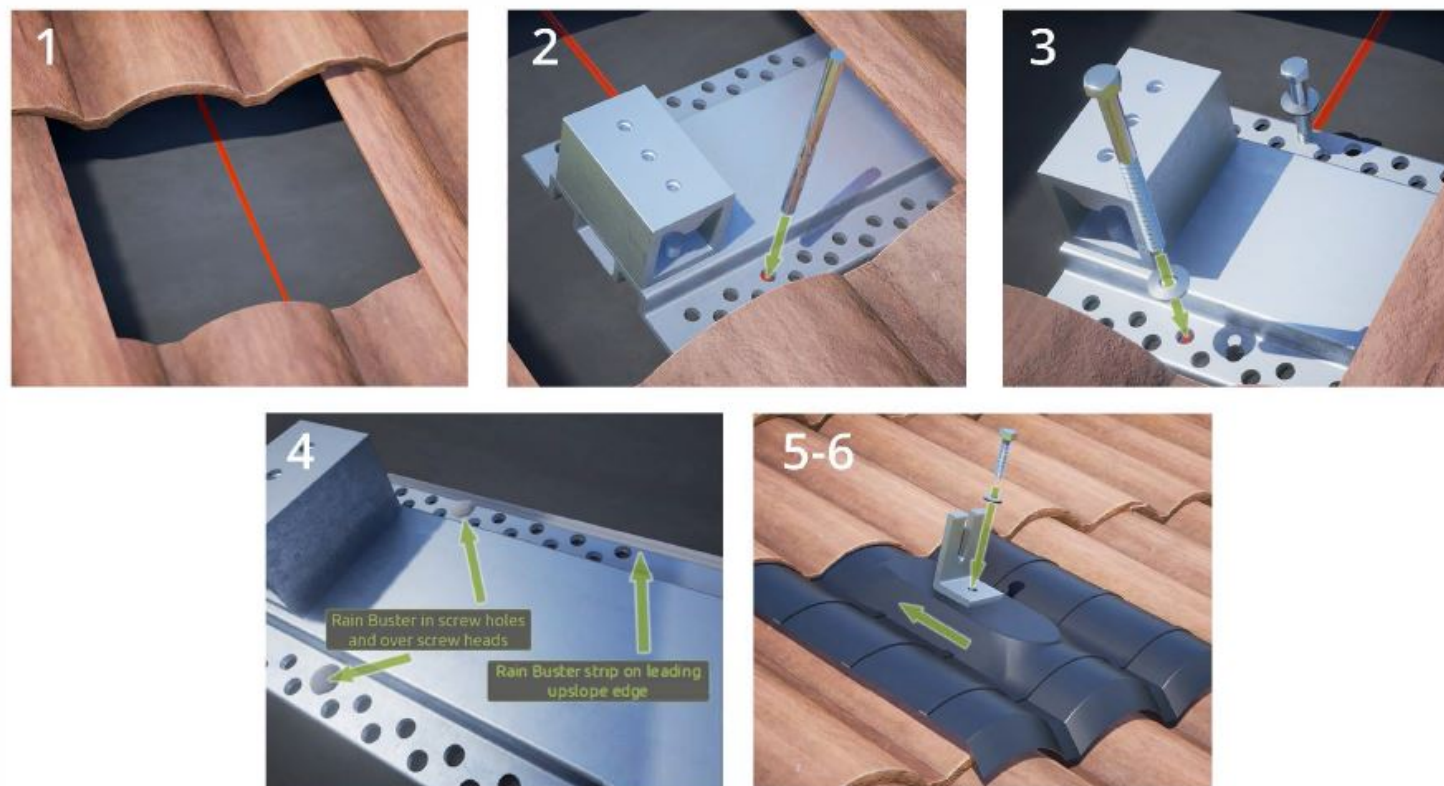

## Tile Flashing System

1. Locate rafter in the typical manner. Remove tile.
2. Predrill lag bolt holes through base and backfill holes with RainBuster.
3. Place base in proper location and install lag bolts with washers in predrilled locations.
4. Apply RainBuster over screw heads and along leading upslope edge of the base.
5. Install Flashing. \*Always install one flashing prior to installing fasteners to verify layout\*
6. Attach compression bracket with provided 5/16"-18 x 1.25" Hex Bolt and EPDM bonded washer, torque to 120-150 in-lb.
7. Re-align adjacent tiles as necessary to create a watertight roof connection.



## PART 1 – GENERAL

### 1.1 SUMMARY

#### A. WORK INCLUDES

1. Removal of tile in desired mounting location. Fasten Tile Flashing Base to rafter using provided lag screws. Install Tile Flashing and attachment bracket per installation instructions.
2. Provide appropriate attachment bracket to interface with array hardware.

### 1.2 SYSTEM DESCRIPTION

#### A. COMPONENTS:

1. Tile Flashing System – Consists of the following:
  - (1) Tile Base – Pre-assembled and sized per tile type
  - (1) Tile Flashing – Pre-formed to match tile profile
  - (1) Compression Bracket
    - a. Tile-TopSlide (allows for attachment of any manufacturer's L-foot)
    - b. L-102-3
    - c. CP-SQ-Slotted (allows for attachment of any manufacturer's L-foot)
  - (1) 5/16"-18 x 1-1/2" Hex Head Cap Screw 18.8 SS
  - (3) 5/16" Diameter EPDM Bonded Washer 18.8 SS
  - (2) 5/16" x 4.0" or 4.5" Hex Head Lag Screw 18.8 SS

#### B. DESIGN REQUIREMENTS:

1. Bracket spacing to be recommended by project engineer.

### 1.3 SUBMITTAL

- A. Submit manufacturer's written specifications.
- B. Submit standard product cut sheets.
- C. Submit installation instructions.

### 1.4 QUALITY ASSURANCE

Installer to be experienced in the installation of specified roofing material and solar installations for not less than 5 years in the area of the project.

### 1.5 DELIVERY / STORAGE / HANDLING

Inspect material upon delivery. Notify manufacturer within 24 hours of any missing or defective items. Keep material dry, covered, and off the ground until installed.

## PART 2 – PRODUCTS

### 2.1 MANUFACTURER

- A. EcoFasten Solar. A division of Vermont Slate & Copper Services Inc., 289 Harrel St. Morrisville, VT 05661, (888) 766-4273 [www.ecofastensolar.com](http://www.ecofastensolar.com)

### 2.2 MATERIALS

- A. Tile Base – 6000 Series Aluminum with 18.8 SS screws pre-assembled.
- B. Tile Flashing – .032" Kynar 500® / Kylar 5000® Pre-Finished 3105 Aluminum
- C. Compression Bracket (choose one)
  - a. Tile Slide- 6061 T-6 aluminum
  - b. L-102-3 - 6061 T-6 aluminum
  - c. CP-SQ-Slotted 6061 T-6 aluminum
- D. 5/16-18 x 1-1/2" HHCS – 18.8 SS
- E. 5/16" Hex Head Lag Screw – 18.8 SS
- F. 5/16" diameter EPDM Bonded Washer – EPDM rubber and 18.8 SS

### 2.3 FINISH

- A. Flashing – Kynar® painted aluminum. Black or Sierra Tan.
- B. All Other Components – Mill Finish.

## PART 3 – EXECUTION

### 3.1 EXAMINATION

- A. Substrate: Inspect roof on which brackets are to be installed. Verify that roofing material has been installed correctly. Notify General Contractor of any deficiencies before installing EcoFasten Solar Brackets.

### 3.2 INSTALLATION

- A. Comply with architectural drawings and project engineer's recommendations for location of system. Comply with manufacturer's written installation instructions for installation and layout.