

# SMART CONDUIT MOUNT W/HW

PART NUMBER	DESCRIPTION
4011017	SMART CONDUIT MOUNT W/HW

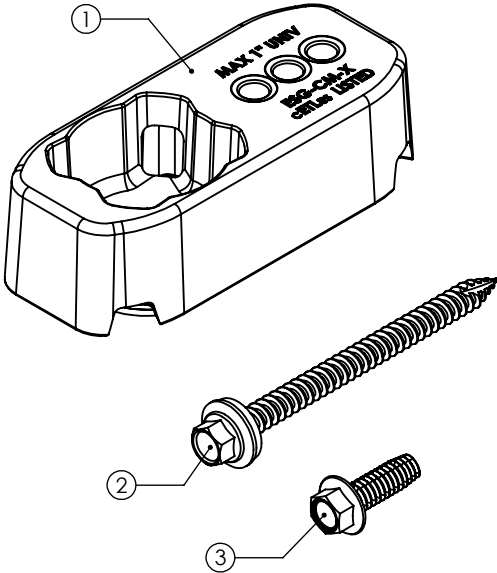

ITEM NO.	DESCRIPTION
1	SMART CONDUIT MOUNT
2	SELF DRILLING SCREW, #14, WOOD TIP, WITH WASHER, EPDM BACKED
3	THREAD ROLLING SCREW, HEX FLANGE HEAD, #1/4 X 3/4

1) SMART CONDUIT MOUNT

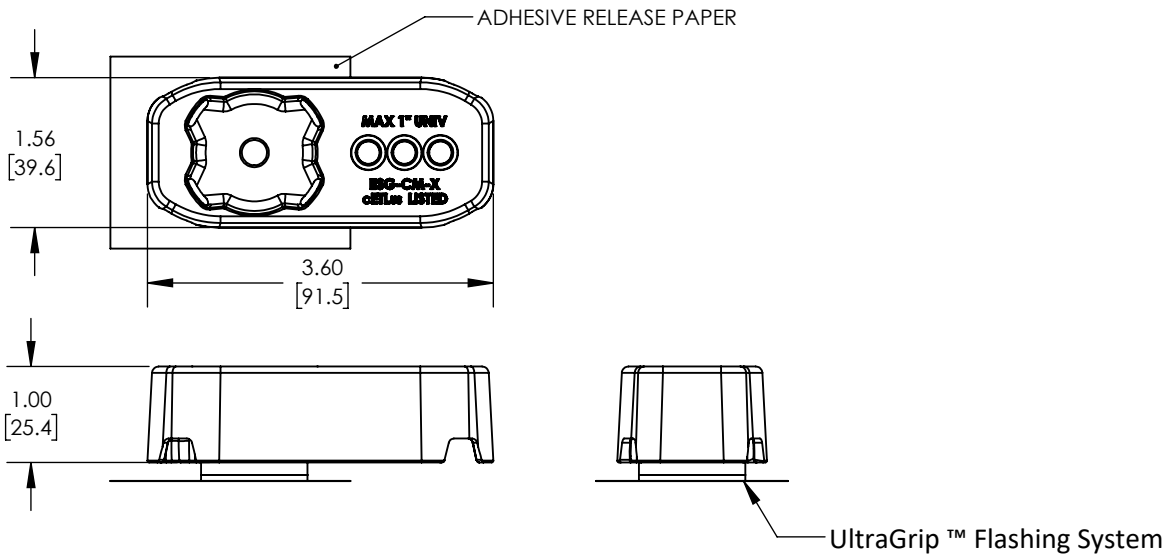

MATERIAL	ALUMINUM
FINISH	MILL

# SMART CONDUIT MOUNT W/HW

2) SELF DRILLING SCREW, #14, WOOD TIP, WITH WASHER, EPDM BACKED

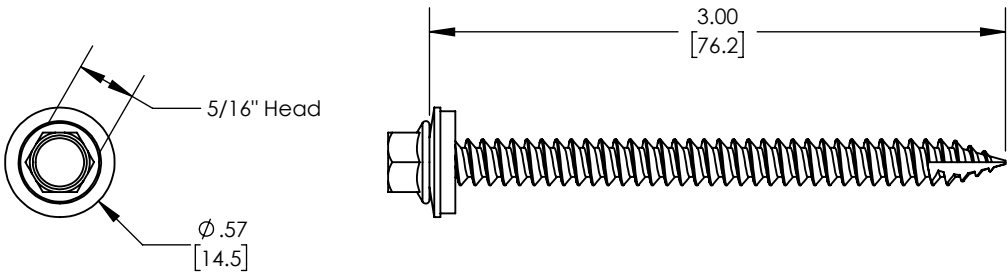

MATERIAL	STAINLESS STEEL, POLYMERIC
FINISH	MILL

3) THREAD ROLLING SCREW, HEX FLANGE HEAD, #1/4 X 3/4

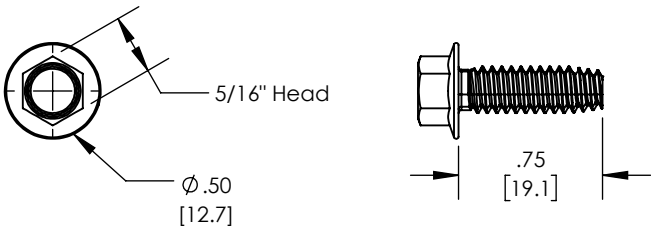

MATERIAL	STAINLESS STEEL
FINISH	MILL